



# Property Information Report

Report Generated On: August 22, 2019 10:30:27 PM

Thompson-Nicola Regional District  
 300 - 465 Victoria St  
 Kamloops, BC V2C 2A9  
 T (250) 377-8673  
 F (250) 372-5048  
 E [gisinfo@tnrd.ca](mailto:gisinfo@tnrd.ca)

7001 Savona Access Rd

## Parcel Description & Location [More Details](#)

**Legal Description:**

L B PL 29469 DL 367

**District Lot:**

367

**Land District:**

KDYD

**Lot Size(Calculated)(+/-5%):**

**Square Meter:**  
3355.91

**Acre:**  
0.829

**Hectare:**  
0.336

**Community:** Savona

**Local Authority:** TNRD (Electoral Area "J")

**School District:** Kamloops/Thompson

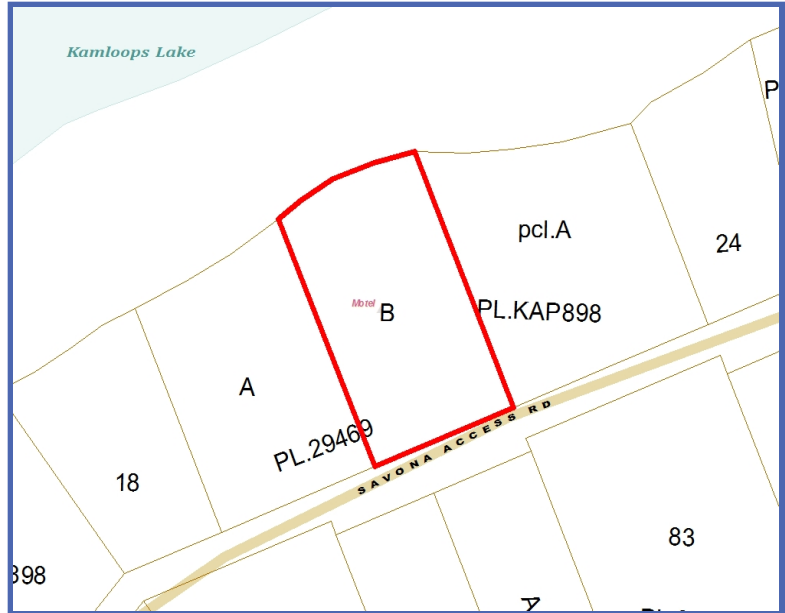

## TNRD Services (Contact the Local Authority for services provided by other jurisdictions) [More Details](#)

**Water Service:** Savona Community Water System

**Sewer Service:** N/A

**Fire Protection:** N/A

## Future Debt (Loan Authorization) (For enquiries, contact the Local Authority) [More Details](#)

**Future Debt:** Savona Water - \$1,200,000

## Planning & Zoning (For enquiries, contact the Local Authority) [More Details](#)

**Zoning Bylaw:** 2400

**Zoning:** C-3

**Lakeshore Development Guidelines (Intersect):** Yes

**Lake Name:** Unknown, Kamloops Lake

**Lake Classification:** Unclassified, Special Case Lake

**Fringe Area:** N/A

**Floodplain Information:** Refer to Local Government floodplain regulation.

**Site Specific Zoning:** N/A

**Development Permit Area:** Riparian DPA

**Official Community Plan Name:** CHERRY CREEK-SAVONA

**OCF Designation:** COMMERCIAL

**Agriculture Land Reserve (Intersect):** No

**Riparian Area (Source: TRIM)(Intersect):** Yes

**Post-Wildfire Geohazard Risk Restrictions:** Unknown

## Development Applications & Permits - from July 2009 to Present (For enquiries, contact the Local Authority) [More Details](#)

Folio:	Development Application Number:	Development Application Type:	Status:		
Folio:	File Number:	Application Date:	Issued Date:	Completion Date:	Status:
<b>Type of Construction:</b>					

## BC Assessment (For enquiries, contact BC Assessment Authority) [More Details](#)

Folio:	Land Title PID:	Assess Year:	Land:	Improvement:	Property Class:
724.00480.602	004-306-988	2019	\$272,000.00	\$227,000.00	6-Bus/Oth
724.00480.602	004-306-988	2019	\$60,400.00	\$50,500.00	1-Res
724.00480.602	004-306-988	2018	\$267,000.00	\$233,000.00	6-Bus/Oth
724.00480.602	004-306-988	2018	\$59,200.00	\$51,700.00	1-Res

Folio:	Actual Use:	Manual class:
724.00480.602	MOTEL AND AUTO COURT	AUTO CRT & MOTEL-BELOW AVERAGE

**Disclaimer:** This drawing is neither a legally recorded map nor a survey and is not intended to be used as such. The information displayed is a compilation of records, information, and data obtained from various sources, and the Thompson-Nicola Regional District (TNRD) is not responsible for its accuracy, completeness or how current it may be. View full [Disclaimer and Terms of Use.](#)